

ADC AD-24

20-lb Capacity Coin Dryer

Standard Features:

- 20-lb. capacity
- 8.10 cu. ft. basket volume
- 60,000 Btu/hr heat input, 400 cfm airflow
- Radial airflow
- Steel door with gasketless glass
- Only 28-1/2" wide
- Available in gas and electric heat



AD-24 Coin Dryer

Why Purchase ADC AD-24?

Engineer-Driven Design That is Built to Last

Our dryers showcase ADC's engineer-driven approach to design. Bearings are permanently lubricated on the motor and drive system. There are no chains used at ADC; rather, we use V-belts and pulleys for smooth, quiet, and trouble-free operation. Our dryer cabinets are electrostatically powder-painted inside and out, then baked at 420-degrees fahrenheit before final assembly—ensuring the hardest surface and the longest-lasting finish in the industry.

Rugged Steel Door with Gasketless Door Glass

Our dryer doors are one solid piece of steel with gasketless glass. This eliminates the issue of glass falling out due to wear and tear on rubber gaskets that some manufacturers use to secure their glass. The security and durability that gasketless glass provides is essential to a successful laundromat operation.

Easy-to-Read, Multilingual Controls

We were the first to bring computer-operated dryers to the market and today we continue to be a leader in applying technology to dryer operation. Our years of experience along with our accessible design, easy-to-read LCD screens and our user-friendly multilingual interface positions ADC as the pioneer in the laundry industry.

Your local ADC independent authorized distributor



ADC AD-24

AD-24 Specifications											
Tumbler Capacity (dry weight)	20 lbs. (9.07 kg)										
Tumbler Diameter	27-1/4" (69.22 cm)										
Tumbler Depth	24" (60.96 cm)										
Tumbler Volume	8.10 cu ft (229.37 L)										
Tumbler/Drive Motor	1/2 hp (0.37 kW)										
Blower/Fan Motor	N/A										
Door Opening (Diameter)	21-1/2" (54.61 cm)										
Door Sill Height	28-1/3" (71.91 cm)										
S.A.F.E. Water Connection	3/4" F.N.P.T.										
Dryers per 20'/40' Container	14 / 30										
Dryers per 48'/53' Truck	42 / 48										
Width	28-1/2" (72.39 cm)										
Depth	36-5/8" (93 cm)										
Height	65" (165.1 cm)										
Airflow gas/electric	60 Hz 400 cfm (11.33 cmm) 50 Hz 333 cfm (9.44 cmm)										
Exhaust Connection	6" (15.24 cm)										
GAS MODEL:	Approx. Net Wt. 426 lbs (193.23 kg) Approx. Ship Wt. 461 lbs (209.11 kg) Heat Input 60,000 btu/hr (15,120 kcal/hr) Inlet Pipe Connection 1/2" M.N.P.T.										
ELECTRIC MODEL:	Approx. Net Wt. 426 lbs (193.23 kg) Approx. Ship Wt. 461 lbs (209.11 kg) Exhaust Connection (diameter) 6" (15.24 cm)										
<table border="1"> <thead> <tr> <th colspan="2">Oven Size per pocket</th> </tr> <tr> <th>kW</th> <th>Btu/hr (kcal/hr)</th> </tr> </thead> <tbody> <tr> <td>18</td> <td>61,400 (15,500)</td> </tr> <tr> <td>20</td> <td>68,200 (17,200)</td> </tr> <tr> <td>24</td> <td>81,900 (20,600)</td> </tr> </tbody> </table>		Oven Size per pocket		kW	Btu/hr (kcal/hr)	18	61,400 (15,500)	20	68,200 (17,200)	24	81,900 (20,600)
Oven Size per pocket											
kW	Btu/hr (kcal/hr)										
18	61,400 (15,500)										
20	68,200 (17,200)										
24	81,900 (20,600)										

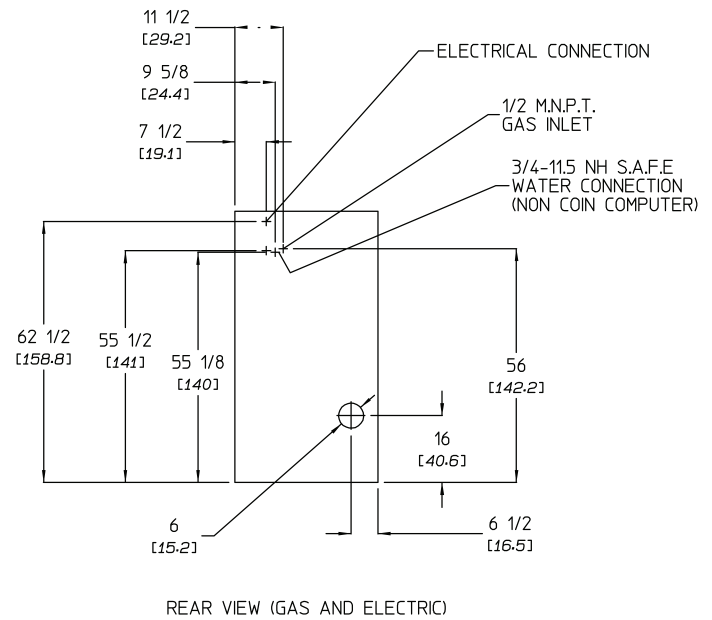
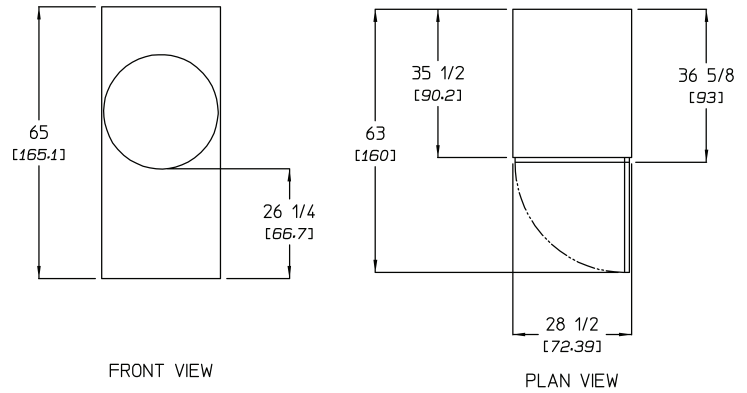

* Not available in steam.

10/04/06

** Specifications in parentheses are metric equivalents.

Electrical Service Specifications					
GAS					
SERVICE VOLTAGE	PHASE	WIRE SERVICE	APPROX AMP DRAW		CIRCUIT BREAKER
			60 Hz	50 Hz	
120	1ø	2	8.7	--	15
208	1ø	2	5.2	--	15
240	1ø	2	4.8	5.8	15
208	3ø	3	3.0	--	15
240	3ø	3	3.2	3.6	15
380	3ø	4*	--	2.2	15
400	3ø	4*	--	2.2	15
416	3ø	4*	--	2.3	15
460	3ø	3	2.1	--	15

* 3-wire is available.

Electrical Service Specifications					
18 kW Electric					
SERVICE VOLTAGE	PHASE	WIRE SERVICE	APPROX AMP DRAW		CIRCUIT BREAKER
			60 Hz	50 Hz	
208	1ø	2	92	--	125
240	1ø	2	--	81	110
240	1ø	2	80	--	100
208	3ø	3	55	--	70
240	3ø	3	48	--	60
20 kW Electric					
208	1ø	3	101	--	150
240	1ø	2	88	--	110
24 kW Electric					
208	3ø	3	72	--	90
240	3ø	3	63	--	80
416	3ø	4*	--	39	50
460	3ø	3	32	--	40



QY160022 6/17

88 Currant Road, Fall River, MA 02720-4781 • 508.678.9000

www.adlaundry.com